

# iCAN PHANTOM

## Quick Set-Up



Scan QR code for Set-Up video

### 1 Power



### 2 Input

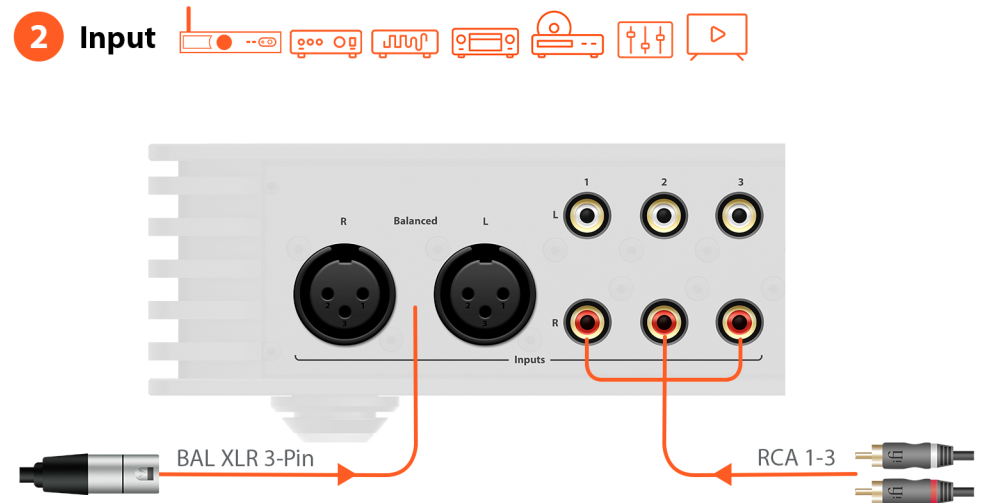

### 3 Analogue output



### 4 Headphones output - Standard

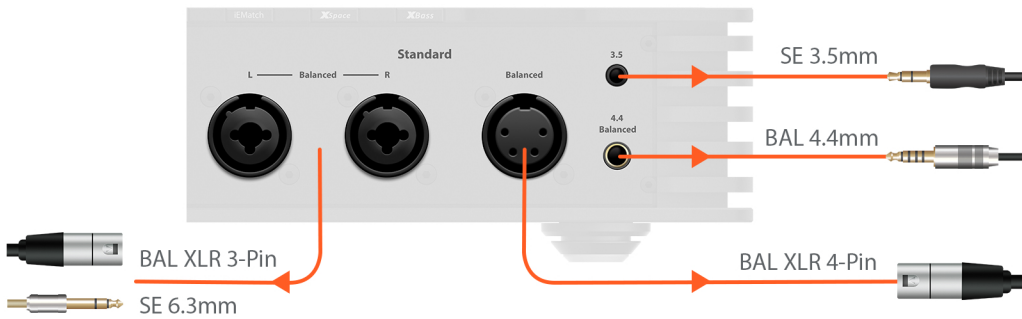

### 5 Headphones output - Electrostatic Normal

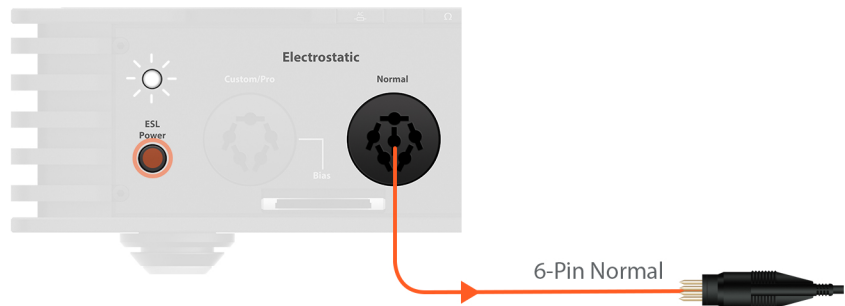

### Custom/Pro



Match bias card to your headphones specification

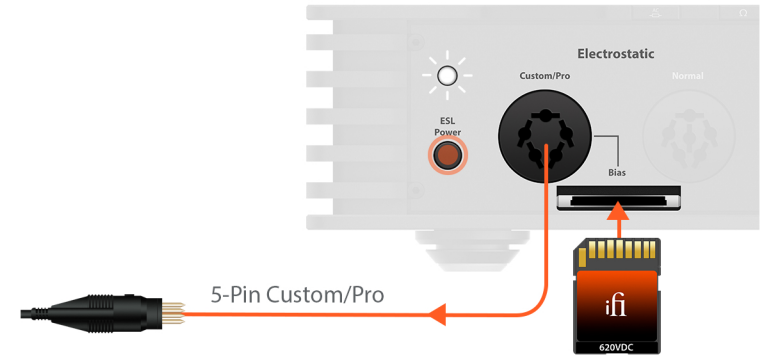

### 6 Volume control

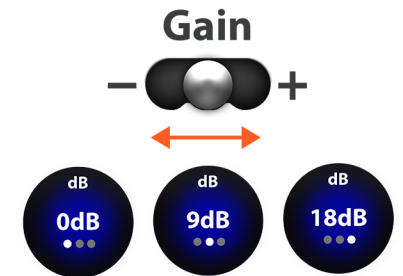
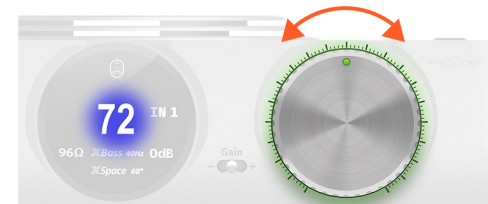

### 7 Circuit modes

